

WARNING LIGHTS

Operating Instruction

CONTENTS

	page	
		1
I Purpose and using		1
II Instruction and technical specification		3
III Products Installation		4
IV Maintenance or repairing		5
V Spare parts		5
VI Appendix		

I Purpose and using

Warning light takes the worry out of barricade lighting perfectly. The warning lights use charged solar as its power supply, so can operate outdoors automatically and is virtually maintenance free. Furthermore it can be associated with conventional battery powered systems. There're some strong advantage such as simply installation, convenient to take, saving costs and green to environment.

II Instruction and technical specification

A daily recharge (even on cloudy days enable) to operate for a minimum of 5 nights for years before the batteries are needed to be replaced. It provides a high visibility for warning and has applications on highway, parking lots, airports, toll stations, building sites, etc.

Specification:		<ul style="list-style-type: none">● <i>Fully compliant with request of the Manual of Uniform Traffic Control Equipment of Europe and Warning & Safety Light Device</i>● <i>Non-polluting</i>● <i>Automatically recharged even on cloudy days</i>● <i>Available in unidirectional or bi-direction models</i>● <i>Available in flash or steady lighting models</i>● <i>Completely waterproof</i>● <i>Maintenance-free</i>● <i>360° swivel base axis</i>● <i>Authority</i> <i>Federal Inspectorate for Heavy Current Installations</i>
Batteries:	Rechargeable	
Case:	High impact polypropylene housing and bases, impervious to ultraviolet degradation	
Types:	Bi-directional or single sided	
Class:	Achieved class L6 of standard EN	
Brightness:	Center of lens intensity: >10cd Edge of lens intensity: 1:3.49 Max intensity: 17.1cd	
Bulbs:	No bulbs, uses high intensity LEDs.	
Viewing Distance:	Viewable on a clear night from distance of 1000 meter	
Operating Time:	5 nights on a single charge; Automatic when ambient light falls below 400 Lux.	
Lens:	High impact polycarbonate lens	
Construction:	Universal mounting SYS with mounting bracket, 360° swivel axis base	
Frequency:	Flash rate 60 times per minute $\pm 15\%$	
Weight:	0.9 kilogram w/ batteries	
Duty cycle	1:10	

2.Appearance & Dimension

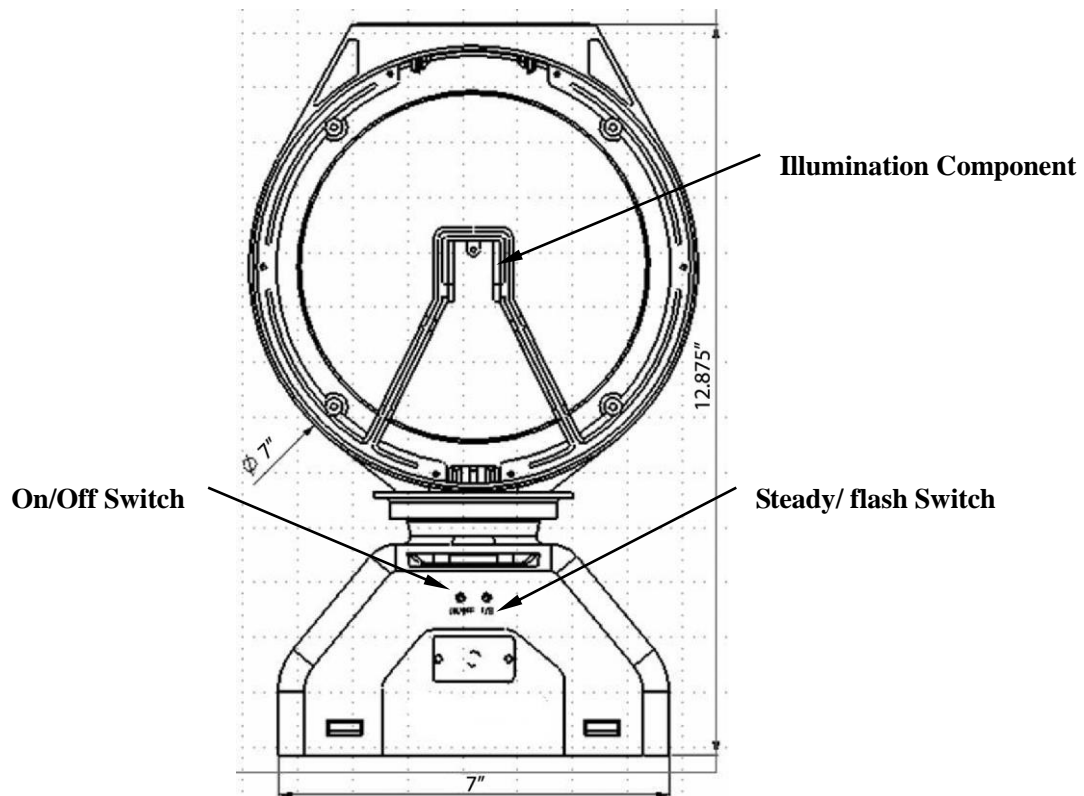

III Products Installation

1. Prepared :

- a) Open the carton, tear the plastic bag and take out the light ;
- b) Check if spare parts are all ready ;

2. Please pay attention on the following when installing :

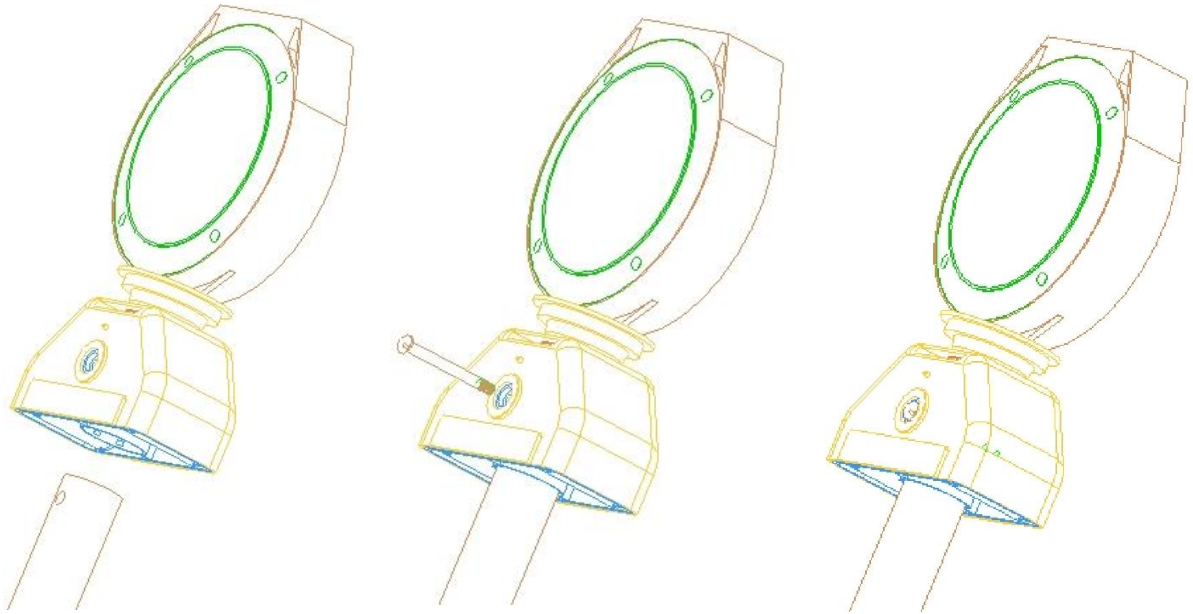

Insert the fixed pole into the Base Insert the Special Bolt into the hole Wind the Special Bolt with Screw Key Tool

Dimension of the fixed pole :

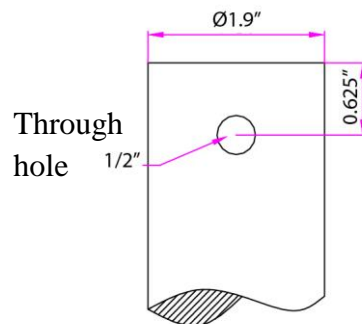

3. Operation Regulation

After installation is done, we need to do a simple test as follows:

- 1) Turn on the inner switch with the accessory Switch Key Tool ;
- 2) When there is dark, the lights will brighten up; however use an opaque object to cover the top solar panel, then the lights will brighten up, either above happened shows that the lights is running.
- 3) Please press the steady/flash switch when need to change from one working style to another.

Note: The working style has been defined before the device shipment. Do not alter

optionally.